

# CB-1-B INSTALLATION INSTRUCTIONS (CMU WALL)

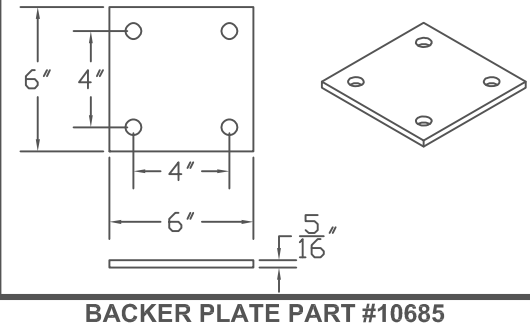

## NOTES:

- CB-1-B WALL ANCHOR INSTALLED BY OTHERS PER GUARDIAN INSTRUCTIONS
- CONCRETE FASTENERS MAY BE EPOXY OR MECHANICAL
- ALLOWABLE STRENGTH VALUES NEED TO BE PROVIDED AND CHECKED BY CONCRETE FASTENER MANUFACTURER
- THE TYPICAL MINIMUM EDGE DISTANCE IS 8"

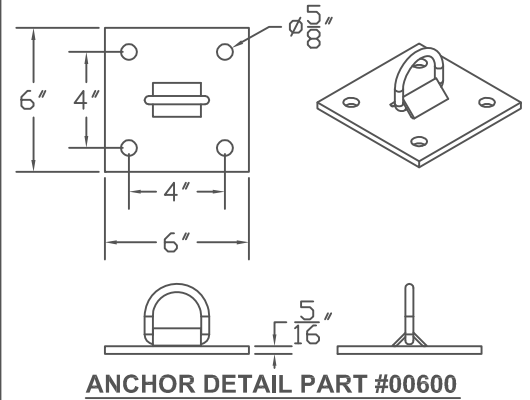
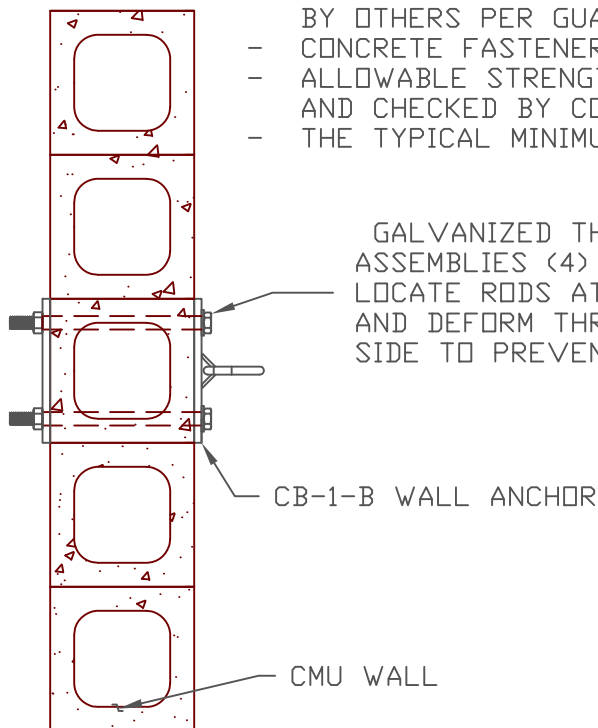

(2) 1/2" WASHERS &  
(4) 1/2"-13 HEX NUTS  
1/2" A307 THREADED ROD  
CUT TO LENGTH IN FIELD



## ANCHOR NOTES:

1. GUARDIAN FALL PROTECTION FALL PROTECTION ANCHORAGES ARE DESIGNED TO BE USED WITH ANSI Z359.1 APPROVED FALL PROTECTION EQUIPMENT.
2. FALL PROTECTION ANCHORAGES ARE DESIGNED FOR AN ULTIMATE LOAD OF 5,000 LBS. WITHOUT FRACTURE OR DETACHMENT. CONTACT A GUARDIAN FALL PROTECTION REPRESENTATIVE FOR CERTIFICATION TO USE AS A WINDOW WASHING TIE-BACK ANCHOR.
3. GUARDIAN FALL PROTECTION DESIGNS THE ANCHOR TO STRUCTURE CONNECTION. THE ABILITY OF THE STRUCTURE TO WITHSTAND THE DESIGN LOADS IS TO BE CHECKED BY OTHERS.



GUARDIAN FALL PROTECTION  
26609 79th AVE SOUTH  
KENT, WA 98032  
(800) 466-6385  
WWW.GUARDIANFALL.COM

## INSTALLATION DETAILS

PRODUCT: CB-1-B ON CMU WALL

PART NUMBER: 00600 & 10685

DATE: 09/23/2011

DRAWN BY: BSD

# CB-1-B INSTALLATION INSTRUCTIONS (STRUCTURAL STEEL)

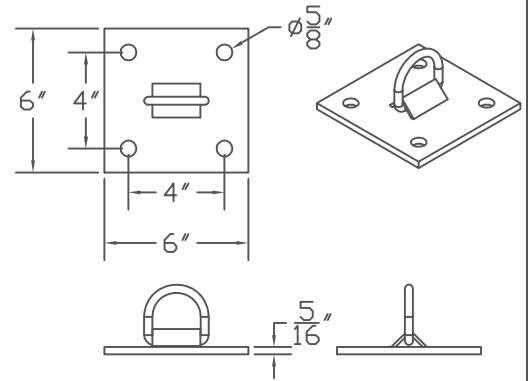

**ANCHOR DETAIL (PART #00600)**

**NOTE:**

- CB-1-B WALL ANCHOR INSTALLED BY OTHERS PER GUARDIAN INSTRUCTIONS

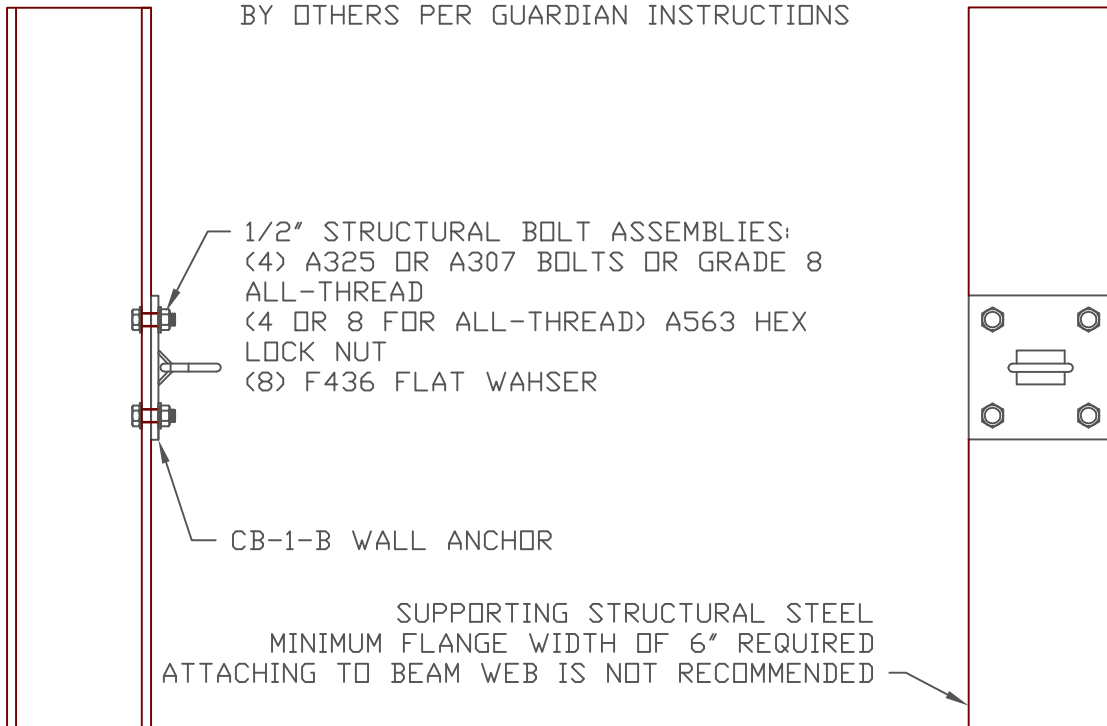

**ANCHOR NOTES:**

1. GUARDIAN FALL PROTECTION FALL PROTECTION ANCHORAGES ARE DESIGNED TO BE USED WITH ANSI Z359.1 APPROVED FALL PROTECTION EQUIPMENT.
2. FALL PROTECTION ANCHORAGES ARE DESIGNED FOR AN ULTIMATE LOAD OF 5,000 LBS. WITHOUT FRACTURE OR DETACHMENT. CONTACT A GUARDIAN FALL PROTECTION REPRESENTATIVE FOR CERTIFICATION TO USE AS A WINDOW WASHING TIE-BACK ANCHOR.
3. GUARDIAN FALL PROTECTION DESIGNS THE ANCHOR TO STRUCTURE CONNECTION. THE ABILITY OF THE STRUCTURE TO WITHSTAND THE DESIGN LOADS IS TO BE CHECKED BY OTHERS.



GUARDIAN FALL PROTECTION  
26609 79th AVE SOUTH  
KENT, WA 98032  
(800) 466-6385  
WWW.GUARDIANFALL.COM

## INSTALLATION DETAILS

PRODUCT:	CB-1-B ON STRUCTURAL STEEL
PART NUMBER:	00600
DATE:	09/23/2011
DRAWN BY:	BSD

# CB-1-B INSTALLATION INSTRUCTIONS (CONCRETE)

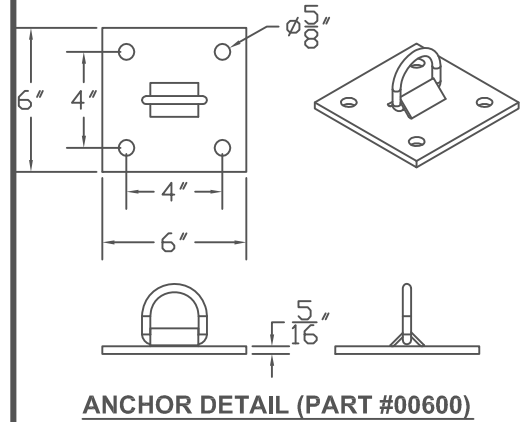

## NOTES:

- CB-1-B WALL ANCHOR INSTALLED BY OTHERS PER GUARDIAN INSTRUCTIONS
- CONCRETE FASTENERS MAY BE EPOXY OR MECHANICAL
- ALLOWABLE STRENGTH VALUES NEED TO BE PROVIDED AND CHECKED BY CONCRETE FASTENER MANUFACTURER
- THE TYPICAL MINIMUM EDGE DISTANCE IS 8"

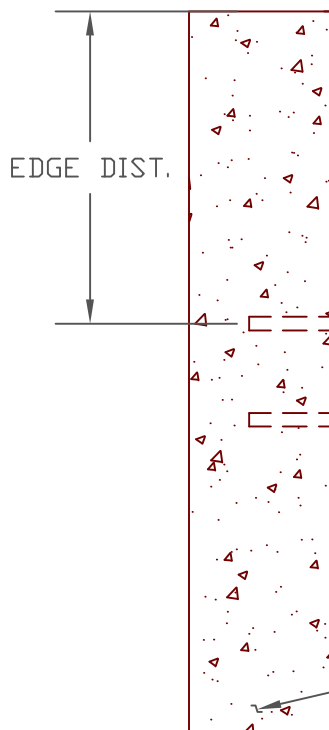

CONCRETE FASTENERS MIN. REQUIREMENTS:  
ALLOWABLE SHEAR = 2,879 LBS  
ALLOWABLE TENSION = 2,015 LBS

CB-1-B WALL ANCHOR

SUPPORTING CONCRETE WALL OR GROUT FILLED CMU  
TYPICAL MINIMUM REQUIREMENTS ARE  
NORMAL WEIGHT, 2,000 PSI & 6" THICK  
CONTACT YOUR LOCAL CONCRETE FASTENER  
SUPPLIER FOR MORE INFORMATION

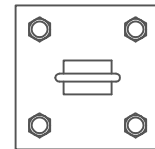

## ANCHOR NOTES:

1. GUARDIAN FALL PROTECTION FALL PROTECTION ANCHORAGES ARE DESIGNED TO BE USED WITH ANSI Z359.1 APPROVED FALL PROTECTION EQUIPMENT.
2. FALL PROTECTION ANCHORAGES ARE DESIGNED FOR AN ULTIMATE LOAD OF 5,000 LBS. WITHOUT FRACTURE OR DETACHMENT. CONTACT A GUARDIAN FALL PROTECTION REPRESENTATIVE FOR CERTIFICATION TO USE AS A WINDOW WASHING TIE-BACK ANCHOR.
3. GUARDIAN FALL PROTECTION DESIGNS THE ANCHOR TO STRUCTURE CONNECTION. THE ABILITY OF THE STRUCTURE TO WITHSTAND THE DESIGN LOADS IS TO BE CHECKED BY OTHERS.



GUARDIAN FALL PROTECTION  
26609 79th AVE SOUTH  
KENT, WA 98032  
(800) 466-6385  
WWW.GUARDIANFALL.COM

## INSTALLATION DETAILS

PRODUCT:	CB-1-B ON CONCRETE
PART NUMBER:	00600
DATE:	09/23/2011
DRAWN BY:	BSD